

8	7	6	5	4	3	2	1
MODEL NO.	"L"	P/N					
PIRIX326T-VL	2000	87530					
PIRIX323T-VL	1000	87529					

NOTE - OPERATING TEMPERATURE -55°C ~ +70°C.
 - MINIMUM BEND RADIUS R60.

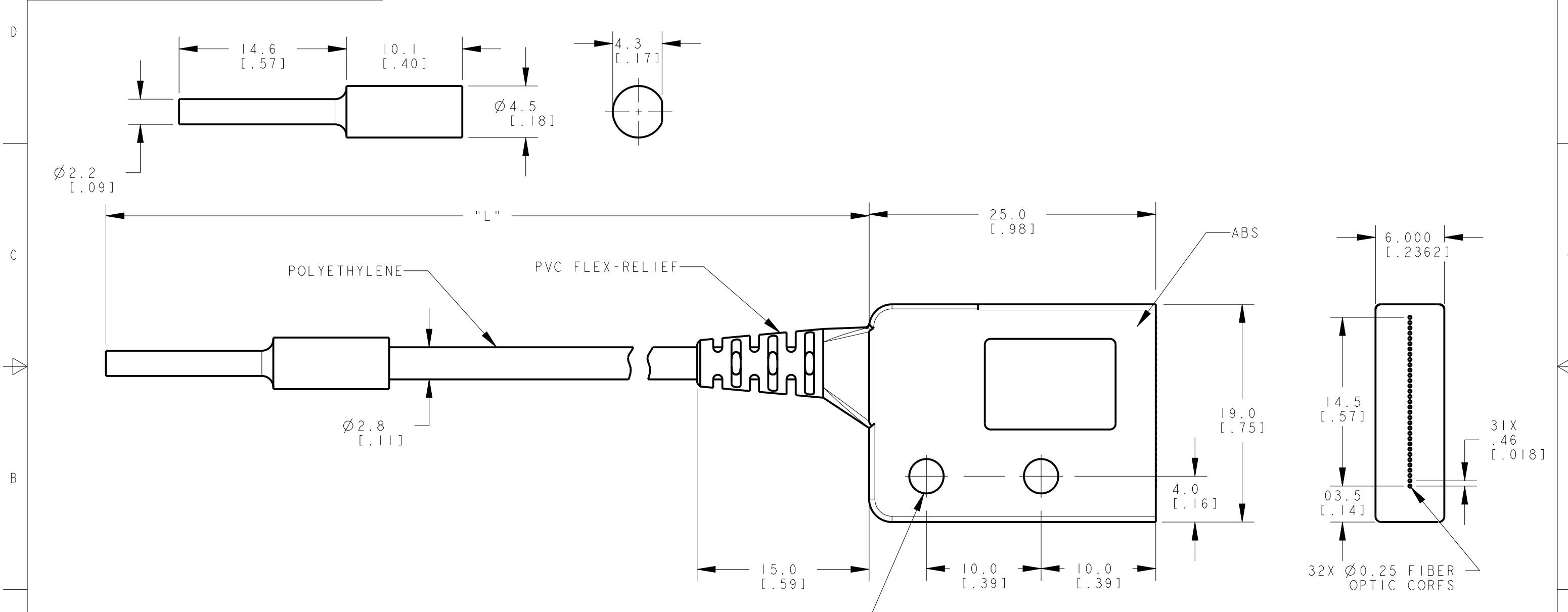

M3 X 0.5
NICKEL PLATED
BRASS INSERT

This drawing is the property of BANNER ENGINEERING CORP. Any use or reproduction, in any form, without prior written permission of Banner is prohibited. © 2015 Banner Engineering Corp.

BANNER BANNER ENGINEERING CORP.
 www.bannerengineering.com

TITLE
PIRIX32 VALUE LINE SERIES TERMINATED

SIZE B DRAWING NO. **178358** REV. **A**

SCALE 3:1 SHEET 1 OF 1 CREO

NOTES:
 1. ALL DIMENSIONS ARE MILLIMETERS [INCHES] UNLESS OTHERWISE NOTED.
 2. REFER TO "www.bannerengineering.com" FOR ADDITIONAL DATA AND SPECIFICATIONS.

