

Models

Clear Glass	Clear Acrylic	Clear Diffusing Acrylic	White Diffusing Acrylic
LEDA70SW-G	LEDA70SW-P	LEDA70SCDW-P	LEDA70SWDW-P

Installing the Replacement Window

1. Remove all the screws and the bezel on the light (Figure 1).
2. Remove the existing window.

NOTE: You do not have to remove the o-ring unless it is damaged and needs to be replaced. Replacement o-rings are available through Banner; see models below. Be sure to remove any debris on the o-ring and the surrounding area before installing the replacement window.

O-Ring Model	Area Light Housing
LEDA70SO	Nickel-plated aluminum
LEDA70SSO	Stainless steel

3. Remove the protective coverings from both sides of the window.

NOTE: Be careful not to touch the inside surface of the window; hold it by the edges only. If necessary, clean the window using lens or window cleaner. For Diffused Window models, place "frosted" (diffused) side of window against o-ring.

4. Place the window onto the light, and secure with the screws and bezel. Tighten screws so that there is no gap between the bezel and the light housing.

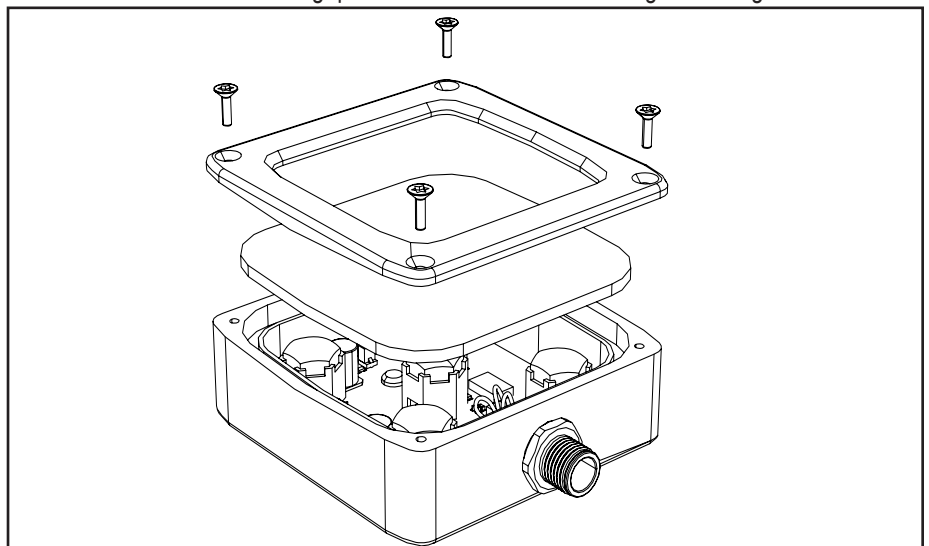

Figure 1. Installing the replacement window on the light